

# 100" 16:9 9mm BLUE OCEAN RPS DRAPE MOUNT SCREEN DIAGRAM

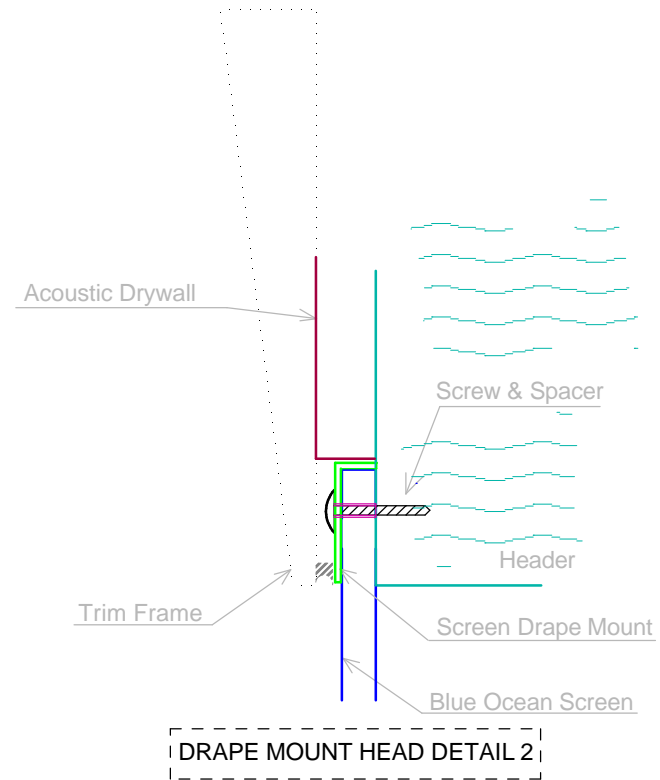

- 1) Keep protective clear sheeting on Screen during the entire installation procedure.
- 2) Confirm Square, Plane and Diagonal of Structure Opening before commencing install as per specified dimensions below.
- 3) Set down 1/2" thick temporary wood plank spacer down across the length of the frame sill.
- 4) Tilt Screen base upon temporary wood plank spacer using adequate/safe number of installers.
- 5) Remeasure center and level in opening; firmly secure bolts or screws through all Screen Drape Mount holes.
- 6) Remove temporary wood plank spacer and drape Screen.
- 7) Frame Trim around Screen capturing between Trim and Structure. Do not block the side or bottom edges.
- 8) If necessary or desired, gaps between Trim/Frame - Screen - Structure may be filled with Dow Corning 795 Caulk

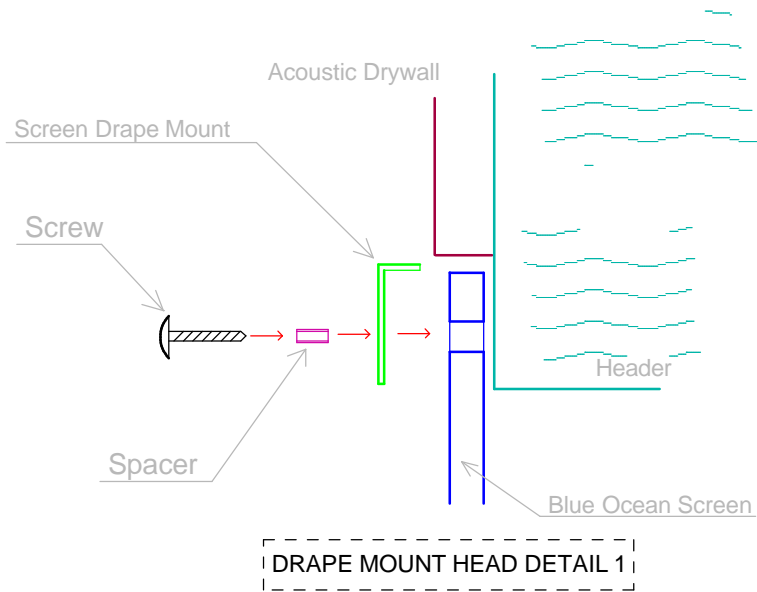
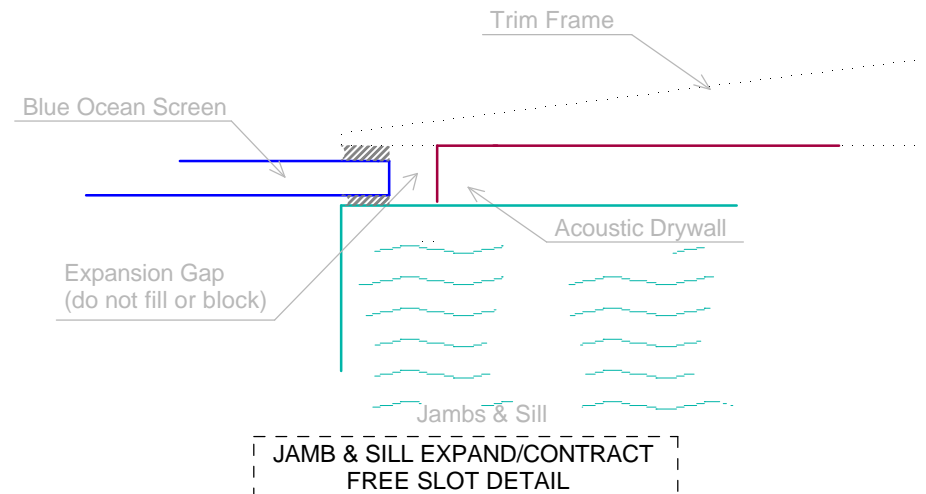

# 100" 16:9 9mm BLUE OCEAN RPS DRAPE MOUNT SCREEN DIAGRAM

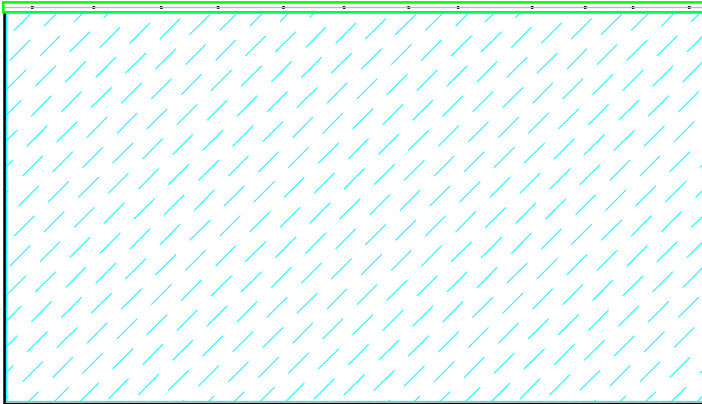

## Suspension Kit

- (1) Drape Mount = 88 1/4" x 1 7/8"
- (10) Screws
- (10) Spacers

## Screen Specifications

- Actual Screen Size = 88.2" x 51 3/4"
- Viewing Area = 87 1/4" x 49"
- Drape Mount = 88 1/4" x 1 7/8"

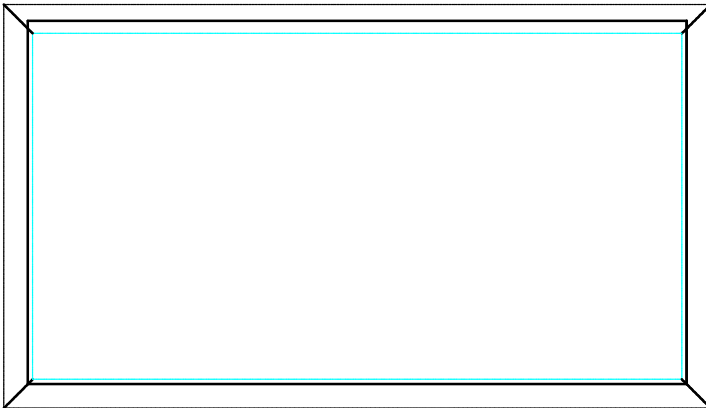

# 120" 16:9 9mm BLUE OCEAN RPS DRAPE MOUNT SCREEN DIAGRAM

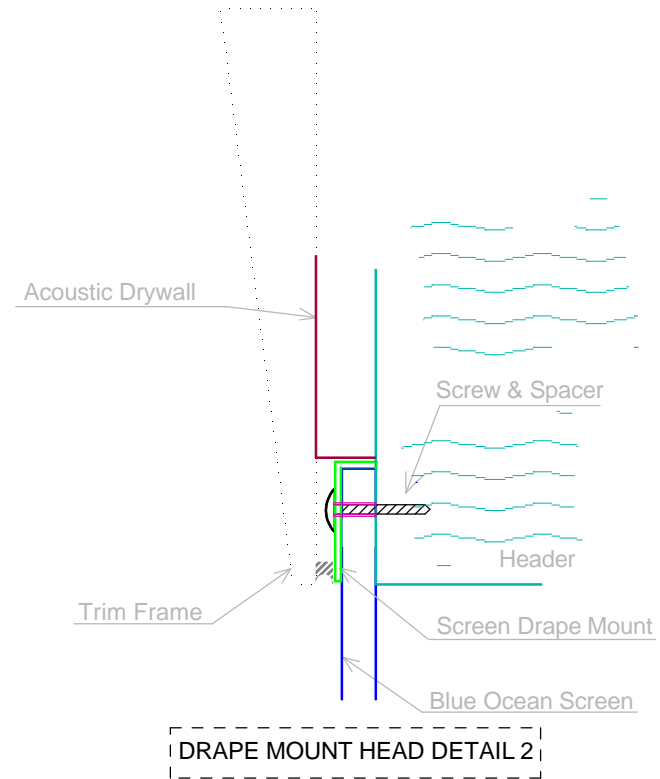
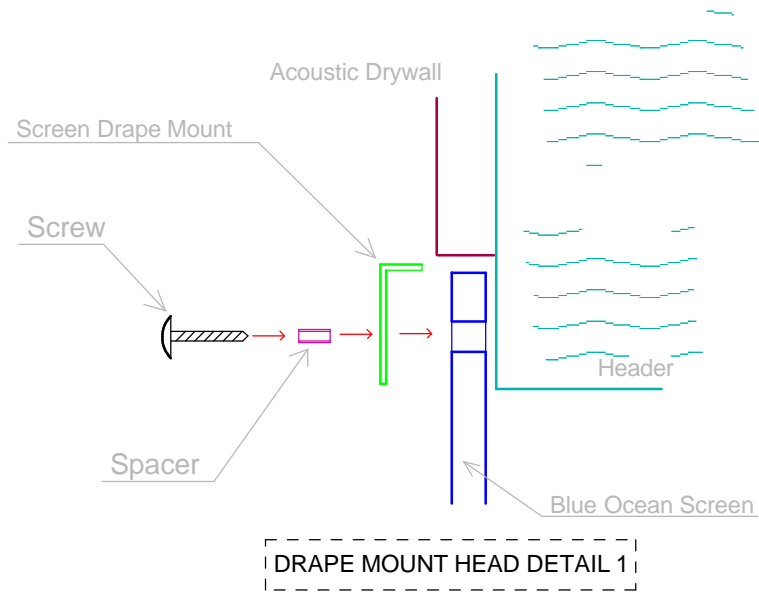

- 1) Keep protective clear sheeting on Screen during the entire installation procedure.
- 2) Confirm Square, Plane and Diagonal of Structure Opening before commencing install as per specified dimensions below.
- 3) Set down 1/2" thick temporary wood plank spacer down across the length of the frame sill.
- 4) Tilt Screen base upon temporary wood plank spacer using adequate/safe number of installers.
- 5) Remeasure center and level in opening; firmly secure bolts or screws through all Screen Drape Mount holes.
- 6) Remove temporary wood plank spacer and drape Screen.
- 7) Frame Trim around Screen capturing between Trim and Structure. Do not block the side or bottom edges.
- 8) If necessary or desired, gaps between Trim/Frame - Screen - Structure may be filled with Dow Corning 795 Caulk

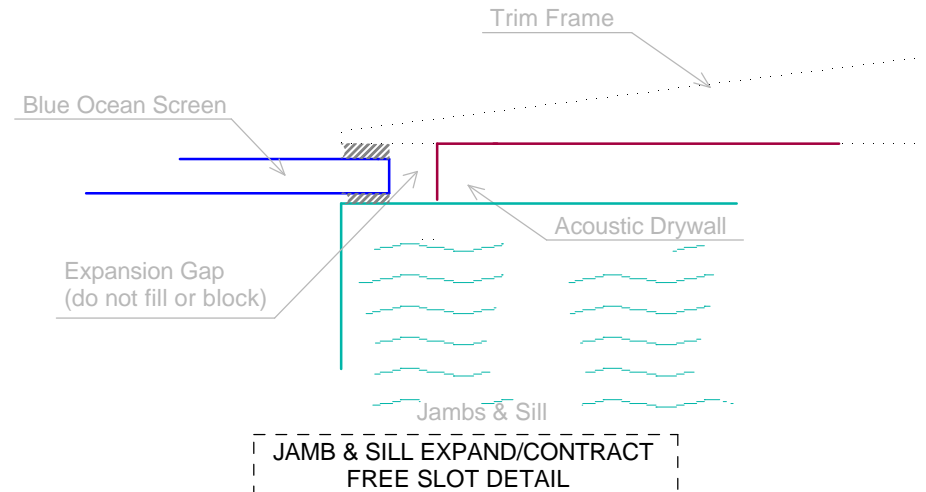

# 120" 16:9 9mm BLUE OCEAN RPS DRAPE MOUNT SCREEN DIAGRAM

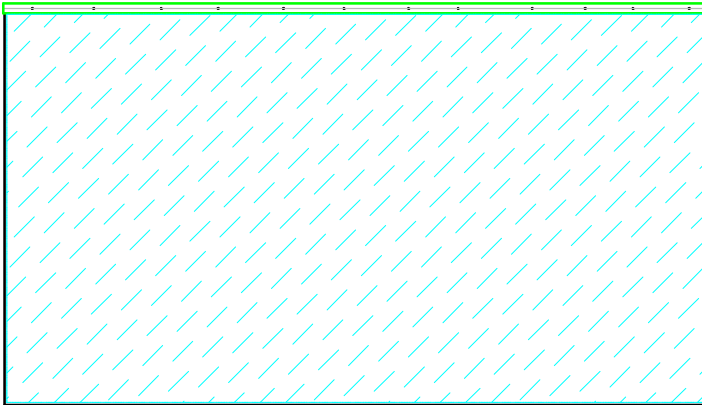

## Suspension Kit

- (1) Drape Mount = 106" x 1 7/8"
- (12) Screws
- (12) Spacers

## Screen Specifications

- Actual Screen Size = 106" x 61 3/4"
- Viewing Area = 104.6" x 58.8"
- Drape Mount = 106" x 1 7/8"

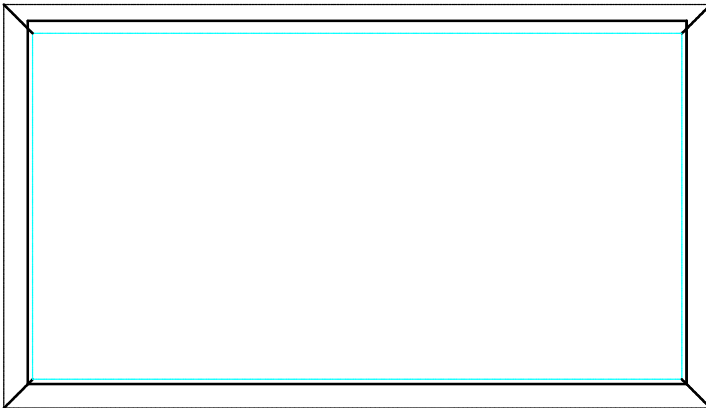

# 150" 16:9 9mm BLUE OCEAN RPS DRAPE MOUNT SCREEN DIAGRAM

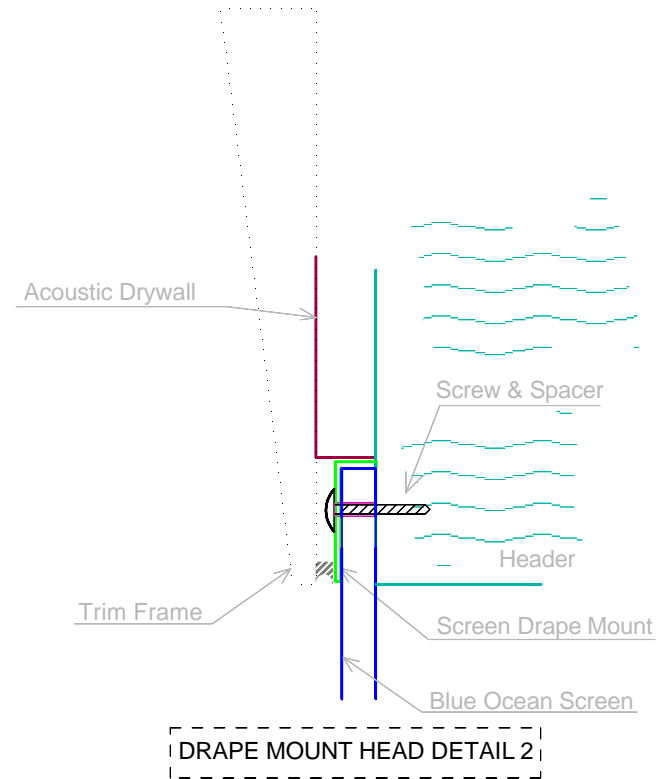
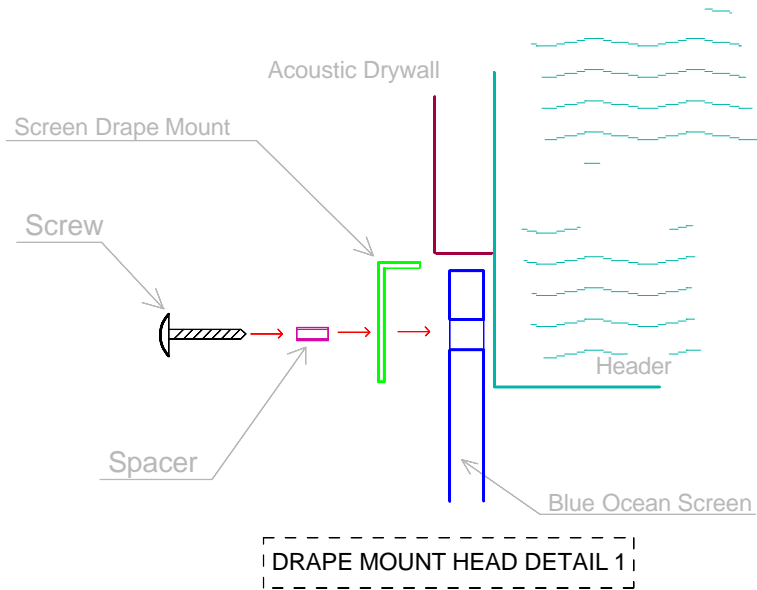

- 1) Keep protective clear sheeting on Screen during the entire installation procedure.
- 2) Confirm Square, Plane and Diagonal of Structure Opening before commencing install as per specified dimensions below.
- 3) Set down 1/2" thick temporary wood plank spacer down across the length of the frame sill.
- 4) Tilt Screen base upon temporary wood plank spacer using adequate/safe number of installers.
- 5) Remeasure center and level in opening; firmly secure bolts or screws through all Screen Drape Mount holes.
- 6) Remove temporary wood plank spacer and drape Screen.
- 7) Frame Trim around Screen capturing between Trim and Structure. Do not block the side or bottom edges.
- 8) If necessary or desired, gaps between Trim/Frame - Screen - Structure may be filled with Dow Corning 795 Caulk

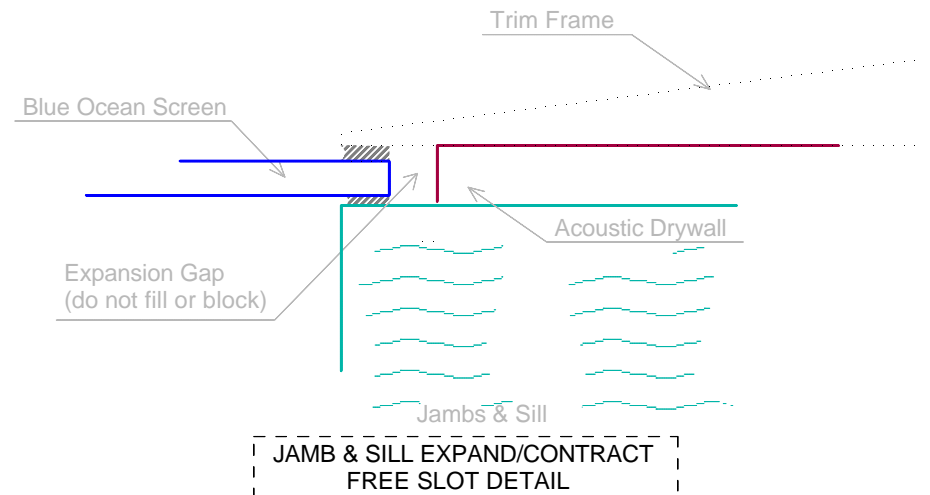

150" 16:9 9mm BLUE OCEAN RPS  
DRAPE MOUNT SCREEN DIAGRAM

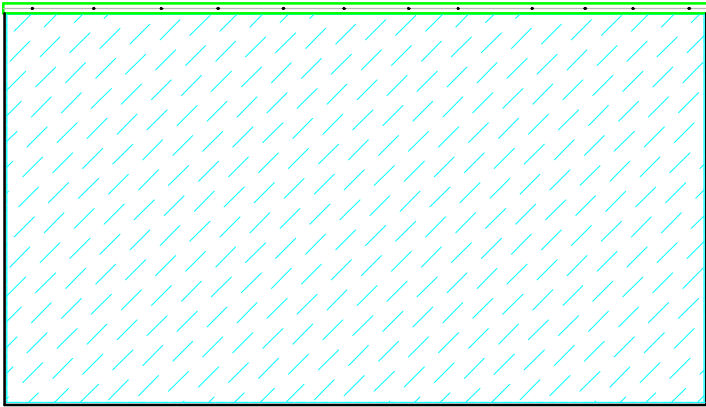

### Suspension Kit

- (1) Drape Mount = 130 3/4" x 1 7/8"
- (14) Screws
- (14) Spacers

### Screen Specifications

- Actual Screen Size = 130 3/4" x 76 1/8"
- Viewing Area = 130.7" x 73 1/2"
- Drape Mount = 130 3/4" x 1 7/8"

